

FLANGE CONNECTIONS

For ductile iron pipes, PN 10 | PN 16



Design features No. 7102

- For ductile iron pipes according to EN 545
- Flange sized and drilled in accordance with EN 1092-2, PN 10 standard; EN 1092-2, PN 16 for DN 200 to DN 400 please specify on order - other standards on request
- The long draw of the fitting and the double chambered gasket result in the pressure being spread well back from the pipe end
- The resilience of the connection prevents tension in the pipe and minimises the danger of breakage

Assembly instructions

- Cut the pipe end straight, do not chamfer or moisten - push the flange onto the pipe and then push the gasket on

Design features No. 7602

- For ductile iron pipes according to EN 545
- Flanges sized and drilled in accordance with EN 1092-2, PN 10 standard; EN 1092-2, PN 16 for DN 200 to DN 300 please specify on order - other standards on request
- Simultaneous pipe restraint and sealing
- This avoids the need for pipe support and additional bolts to counter the effect of axial load and pressure. This connection can be easily dismantled at any time

Assembly instructions

- Assemble the flange with the sleeve gasket and pressure ring, and push onto the piece. Offer up the complete flange to the opposing flange, ensuring that the pressure ring projects approx. 10 mm over the end of the pipe. Cross tighten the nuts and bolts to make the connection. This fitting has the advantage that it can cope with a gap or an uneven cut that extends up to 15 mm from the opposing flange

Material | Technical features

- 1 **Flange** made of ductile iron, epoxy powder coated
- 2 **Grip ring** hardened steel
- 3 **Sleeve gasket** made of elastomer
- 4 **Pressure ring** made of ductile iron, epoxy powder coated
- 5 **Seal** made of elastomer

Double chamber flange adapter

No. 7102
Standard

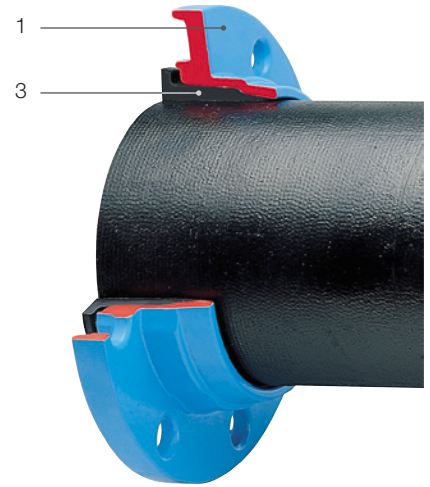

Flange adapter

No. 7602
Restraint

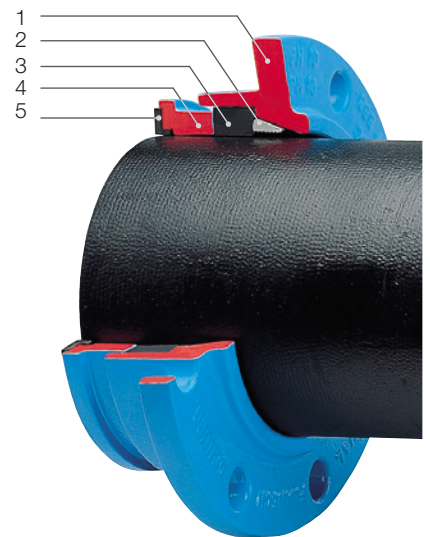

Tip: When shortening ductile iron pipes, observe the Ø; Heed pipe manufacturer's advice

Order No.	Version	MOP (PN)	Flange DN / Ø Pipe															
			40	50	60	60	65	80	80	100	125	150	200	250	300	400		
7102	Double chamber flange adapter, standard	16	56	66	77	82	82	98	101	118	144	170	222	274	326	429		
7602	Flange adapter, restraint											1	*1	*1	*1			
0102	Flange adapter, standard																	

Explanation: * also available in PN 16, ¹Flange with larger an extended hole circle are not suitable for use with fixed studs!



E. Hawle Armaturenwerke GmbH 4840 Vöcklabruck - Austria - Wagrainstraße 13
Tel.: +43 (0) 7672 72576 0 - Fax: +43 (0) 7672 78464 - E-Mail: hawle@hawle.at - www.hawle.com

C 4/1

FLANGE CONNECTIONS

For ductile iron pipes, PN 10 | PN 16



No. 7102 / 0102

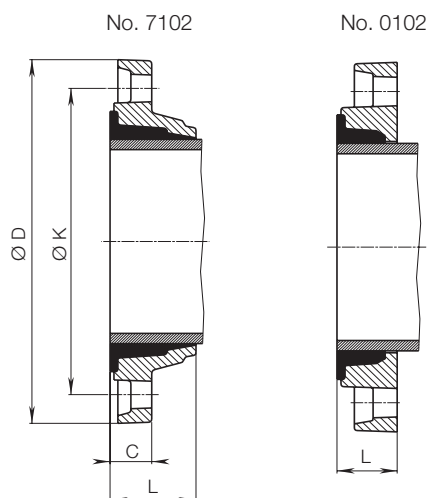

Flange DN	Ø Pipe	Ø D		Ø K	C		L		Bolts		Weight	
		7102	0102		7102	7102	0102	Quantity	Thread	7102	0102	
50	66	165		125	22	56		4	M 16	1,8		
60	77	175	175	135	28	56	35	4	M 16	3,1	2,4	
60	82		175	135			35	4	M 16		2,4	
65	82	185		145	29	58		4	M 16	3,4		
80	98	200	200	160	22	64	38	8	M 16	2,6	3,1	
80	101	200		160	22	64		8	M 16	2,4		
100	118	220	220	180	23	62	38	8	M 16	2,8	3,8	
125	144	250	250	210	24	66	42	8	M 16	4,2	5,3	
150	170	285	285	240	25	66	45	8	M 20	4,7	7,0	
200	222	340	340	295	30	71	45	8	M 20	7,6	10,5	
250	274	400		350	32	78		12	M 20	10,9		
300	326	455		400	33	82		12	M 20	13,8		
400	429	570	580	515	37	103	61	16	M 24	22,0	22,5	

No. 7602

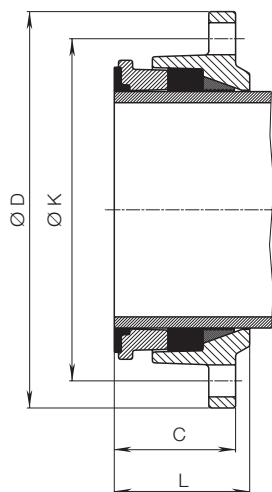

Flange DN	Ø Pipe	Ø D	Ø K	C	L	Bolts		Weight
						Quantity	Thread	
40*	56	150	110	26	58	4	M 16	1,6
50	66	165	125	60	71	4	M 16	2,9
60	77	175	135	60	73	4	M 16	3,2
65	82	185	145	63	79	4	M 16	3,7
80	98	200	160	59	76	8	M 16	3,9
80	101	200	160	59	76	8	M 16	3,5
100	118	220	180	60	78	8	M 16	4,6
125	144	250	210	62	85	8	M 16	6,0
150	170	285	240	87	98	8	M 20	9,3
200	222	340	295	90	105	8	M 20	14,0
250	274	400	355	90	105	12	M 20	17,5
300	326	455	405	90	105	12	M 20	21,7

* DC flange with thread pin

C 4/2



E. Hawle Armaturenwerke GmbH 4840 Vöcklabruck - Austria - Wagrainstraße 13
Tel.: +43 (0) 7672 72576 0 - Fax: +43 (0) 7672 78464 - E-Mail: hawle@hawle.at - www.hawle.com